



**BABY
BRIGHTNESS**

FlexGo Duo

Model: S906D

Instruction manual

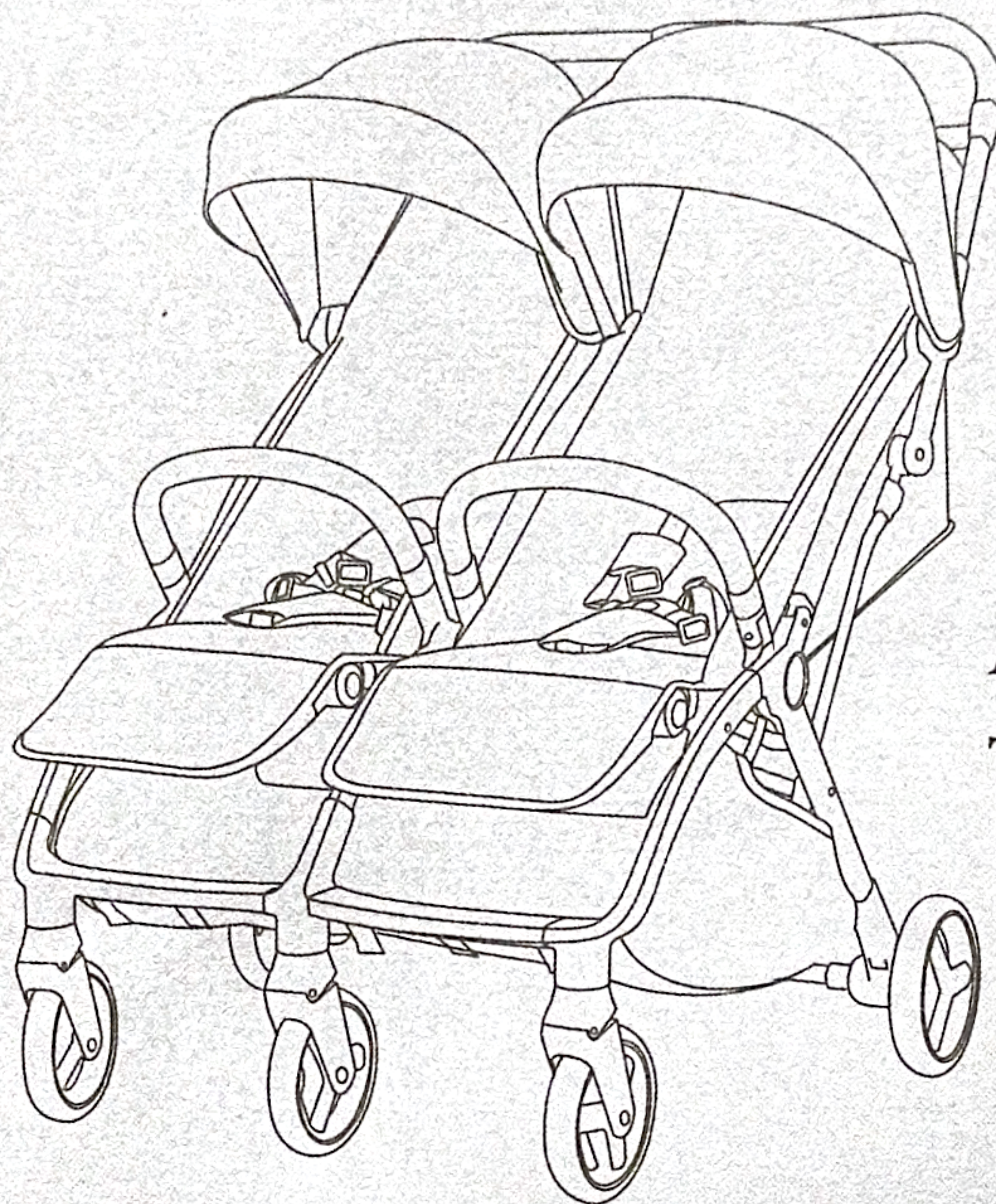

**Automatic Fold
Twin Stroller**

**Max 22kgs
Birth to approx. 4 years**

IMPORTANT: PLEASE KEEP THESE INSTRUCTIONS FOR FUTURE REFERENCE.

IMPORTANT: Please read these instructions carefully before use and keep for future reference.

This stroller complies with EN 1888-1:2018+A1:2022 & EN 1888-2:2018+A1:2022.

- **WARNING** NEVER LEAVE THE CHILD UNATTENDED
- **WARNING** ENSURE THAT ALL THE LOCKING DEVICES ARE ENGAGED BEFORE USE.
- **WARNING** TO AVOID INJURY ENSURE THAT THE CHILD IS KEPT AWAY WHEN FOLDING AND UNFOLDING THIS PRODUCT
- **WARNING** DO NOT LET THE CHILD PLAY WITH THIS PRODUCT
- **WARNING** ALWAYS USE THE HARNESS RESTRAINT SYSTEM
- **WARNING** THIS PRODUCT IS NOT SUITABLE FOR RUNNING OR SKATING
- **WARNING** ALWAYS APPLY THE BRAKE WHENEVER THE STROLLER IS STATIONARY.
- **WARNING** DO NOT CARRY EXTRA CHILDREN OR BAGS IN THIS STROLLER
- **WARNING** ALWAYS USE THE CROTCH STRAP OF THE HARNESS IN COMBINATION WITH THE WAIST AND SHOULDER BELT.
- **WARNING** WHEN NOT IN USE DISCONNECT SHOULDER STRAPS FROM THE WAIST STRAP AND/OR BUCKLE.
- **WARNING** MAKE SURE CHILDREN ARE KEPT CLEAR OF ANY MOVING PARTS IF YOU ADJUST THE STROLLER.
- **WARNING** THIS STROLLER IS DESIGNED FOR USE FROM 0 TO APPROX. 4 YEARS OR UP TO 22KG per seat, WHICHEVER COMES FIRST. This stroller is only suitable for two children, with a maximum weight capacity of 44kg.
- **WARNING** THE MAXIMUM AUTHORIZED LOAD FOR THE SHOPPING BASKET IS 2KG.

- **WARNING** THE CHILD MUST BE SECURED AT ALL TIMES BY THE 5 POINT SAFETY HARNESS
- **WARNING** HANGING ITEMS OR LOADS ON THE HANDLE BAR MAY IMPAIR THE STROLLER'S STABILITY.
- **WARNING** BEFORE ASCENDING OR DESCENDING ESCALATORS OR STAIRS, ALWAYS REMOVE CHILD AND FOLD THE STROLLER.
- **WARNING** KEEP THE STROLLER AWAY FROM OPEN FIRE, EXPOSED FLAME HEATERS AND OTHER SOURCES OF STRONG HEAT
- **WARNING** IT IS RECOMMENDED TO PERIODICALLY CLEAN ALL MOVING PARTS IN ORDER TO MAINTAIN PROPER FUNCTIONING OF THE STROLLER.
- **WARNING** IT IS RECOMMENDED TO REGULARLY TEST AND CHECK THAT THE LOCKING MECHANISM IS FUNCTIONING PROPERLY AND HAS NOT BEEN DAMAGED PRIOR TO USAGE.
- **WARNING** ENSURE THE BRAKE IS ENGAGED BEFORE PLACING YOUR BABY IN AND OR REMOVING YOUR BABY FROM THE STROLLER.

CARE AND MAINTENANCE

- Always use a non-toxic, non-abrasive cleaning agent or solvent to clean your stroller.
- It is recommended to use a solution of water and a small amount of mild, non-toxic detergent. Clean the stroller with a clean, damp cloth.
- The fabric parts may be removed and machine washed. (Max. Temp: 30°C)
Do not use strong detergents or bleach.
- If you need to put your stroller in storage for any period of time, ensure storage area is well ventilated at all times and avoid storing in a damp, hot and or humid environment.
- Always use the rain cover when raining.
- If stroller does get wet, ensure it is thoroughly dry again before folding and storing it.

Unfolding



- 1、 Open the folding lock (as show in pic .1and pic2).
- 2、 Lift the handlebar,then stroller unfolds(as show in pic.3 and pic.4).

Folding

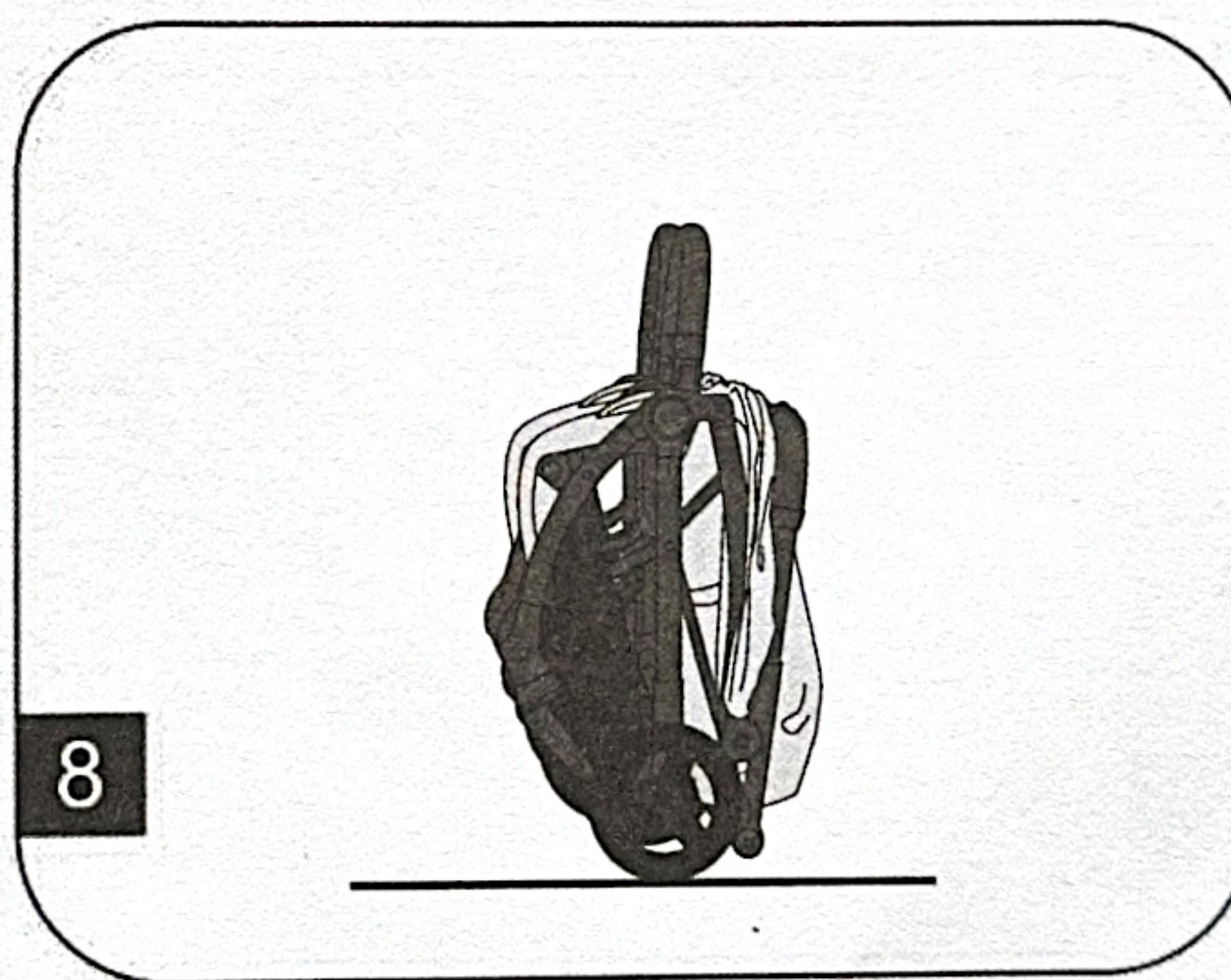
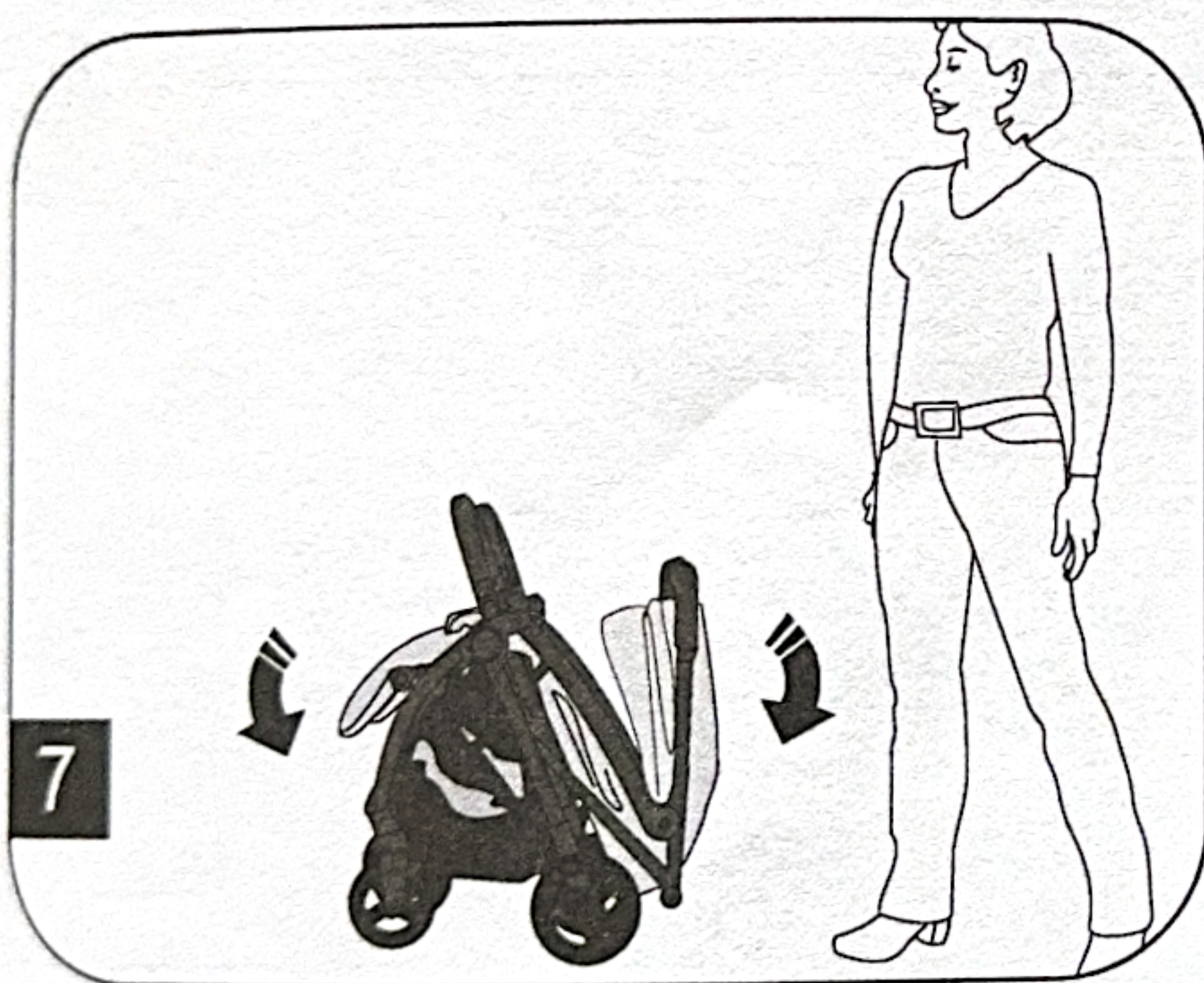

1. Please close the hood first(as pic.5)
2. Press the two keys simultaneously(as pic.6)
3. The stroller will be folded automatically (as pic.7)

Seat Back Adjustment

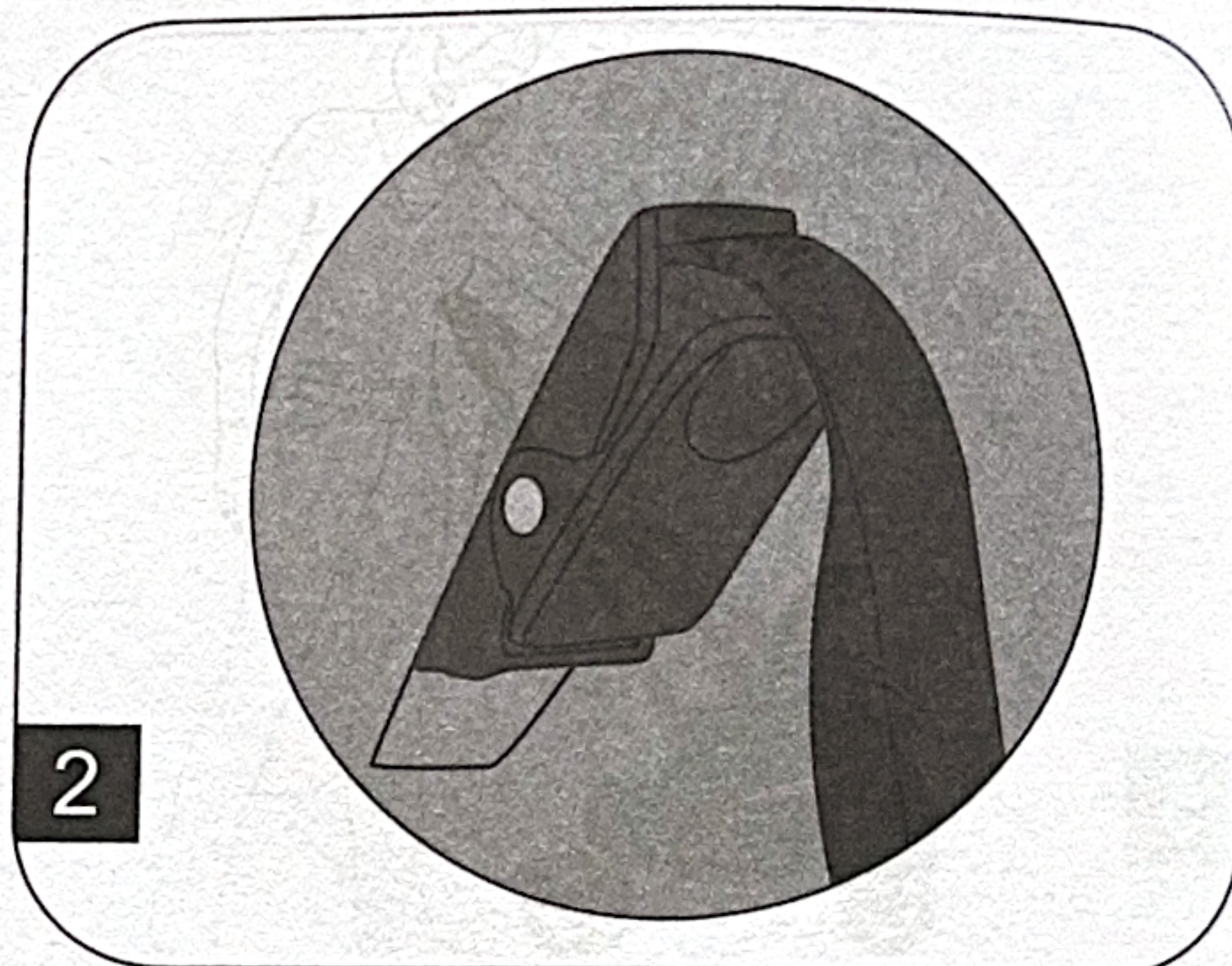

Legrest Adjustment

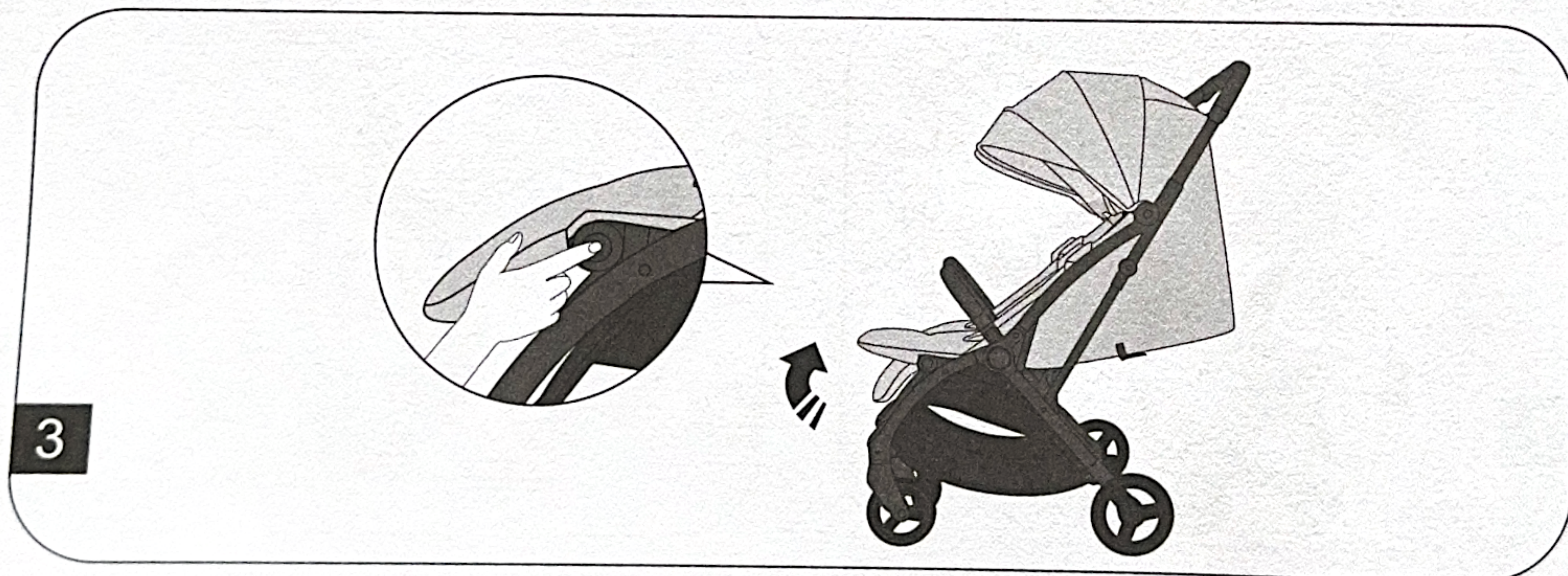

- 1、 The seat backrest can be adjusted from most upright position to reclined position by adjusting the buckle(as pic.1)
2. To adjust the legrest, press the buttons on both sides of the legrest to move it up or down. (as pic. 3)

Fasten&Loosen Seat Belt

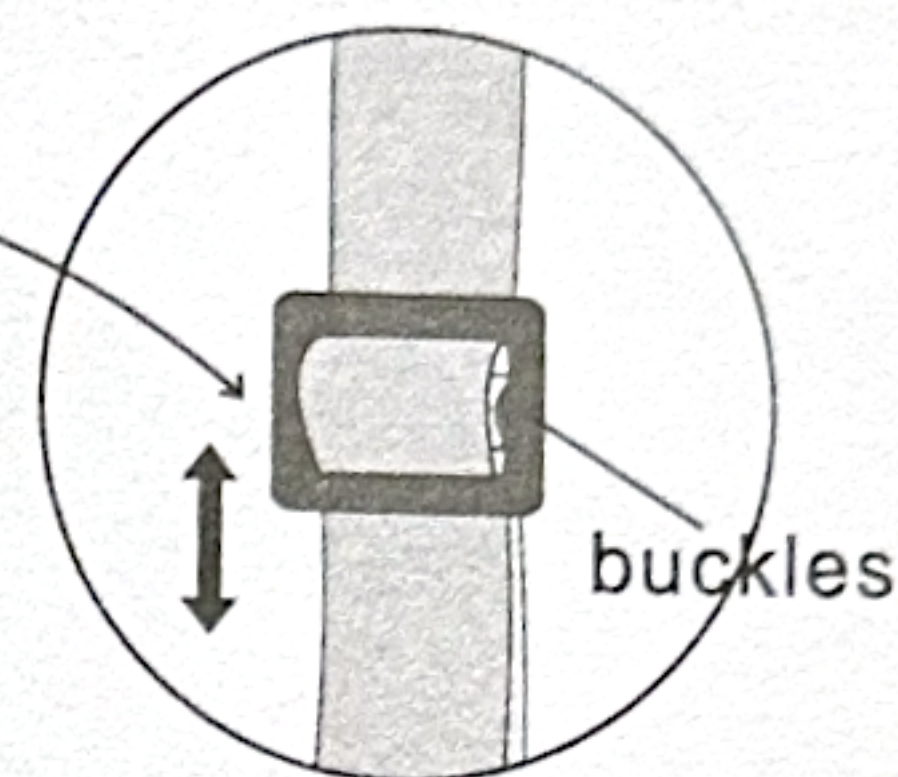
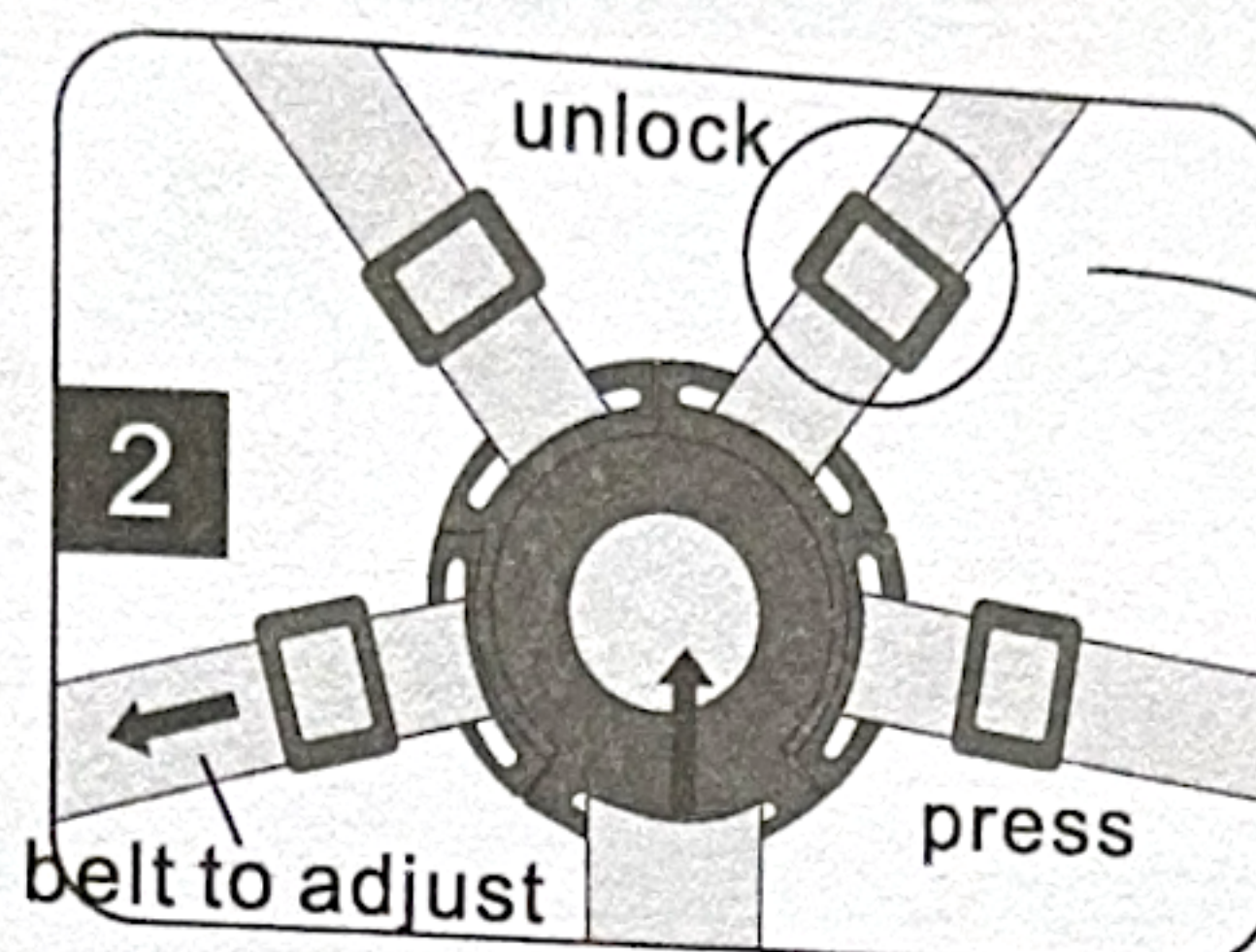
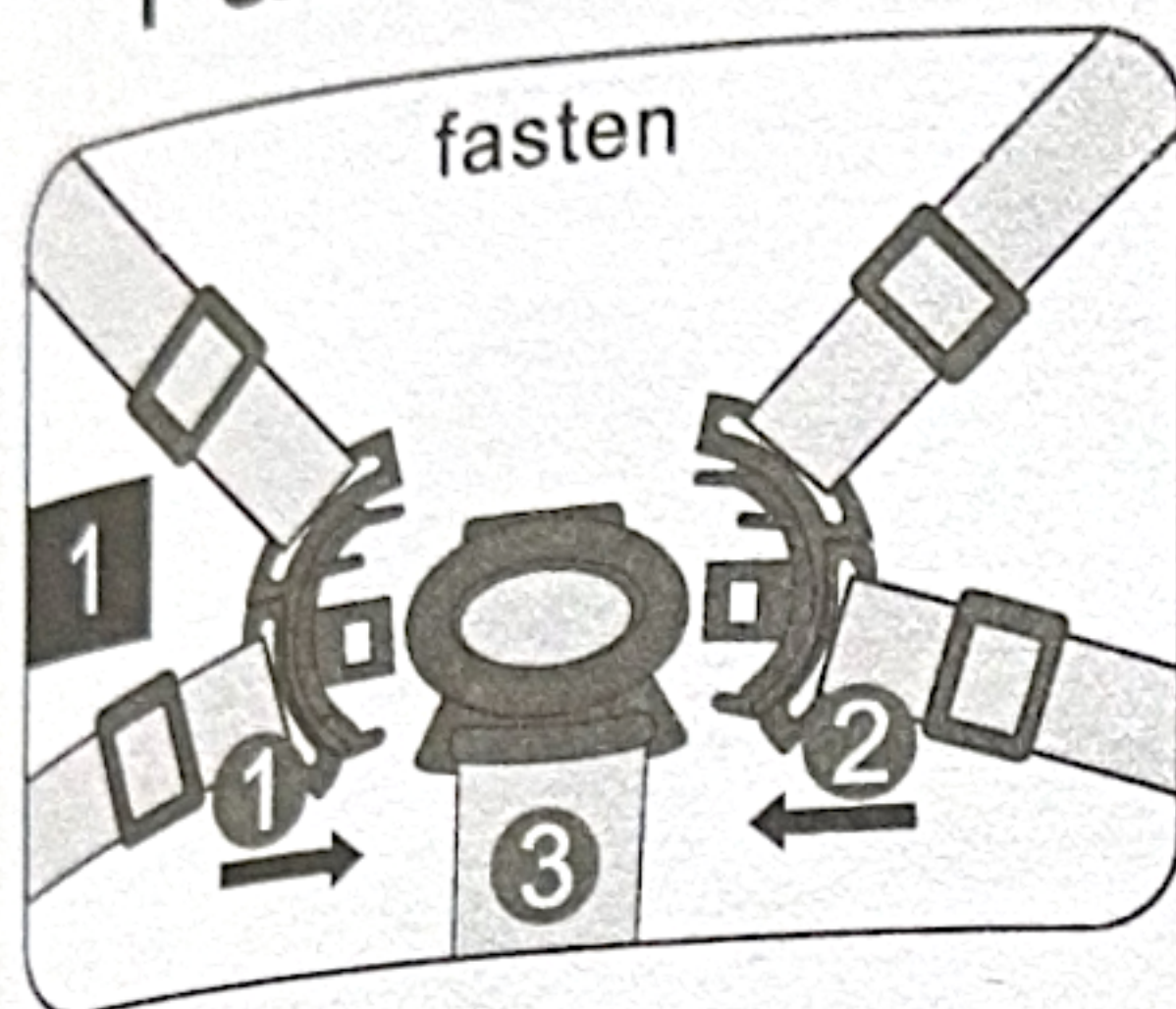

1. 1 and 2 are clasped on 3, then the seat belt can be fastened (as pic. 1)
2. Press the middle button, then the seat belt can be loosened (as pic. 2)
3. Safety belt adjustment: pull one end of the safety belt and slide the button up and down to adjust the length of the belt
4. The shoulder strap can be adjusted in 2-position (as pic. 3)
5. Take out the waist strap and shoulder strap from the hole in the backrest, insert it into the hole to be adjustable.
6. Insert the bumper into the joint as pictures show you to fix the bumper (as pic. 4)
7. Pull the plastic as the picture shows to take off the bumper (as pic. 4)

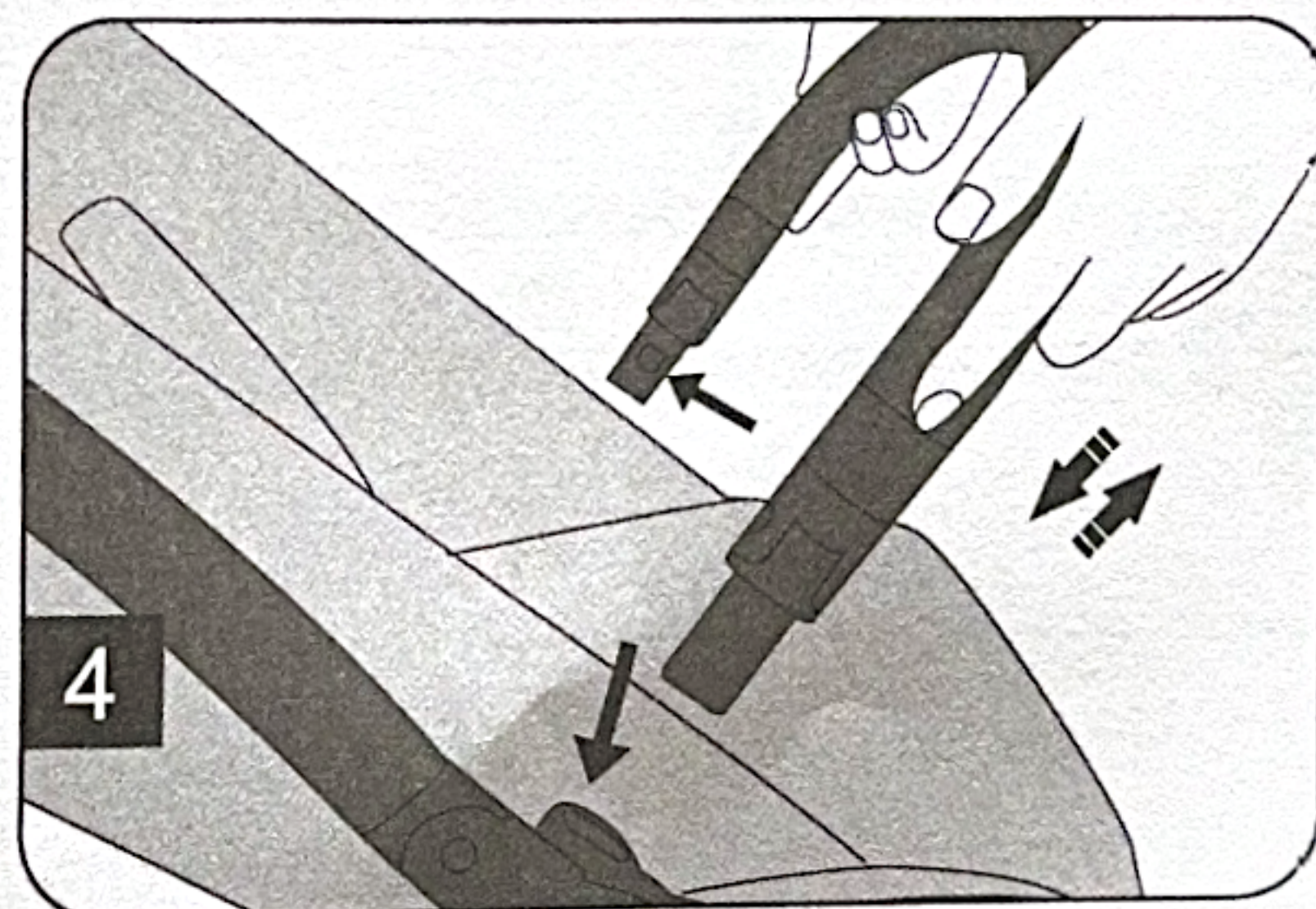
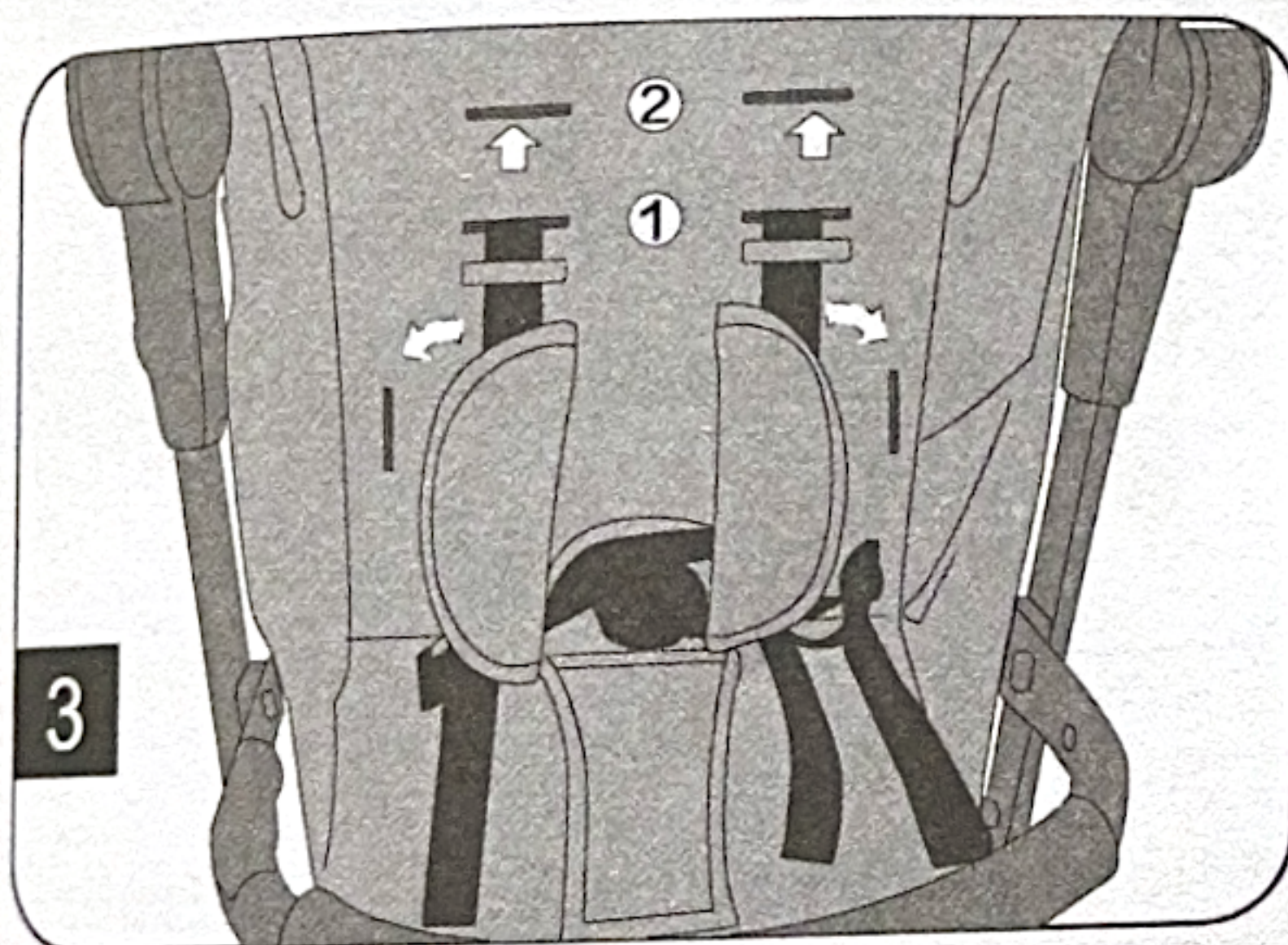

How to assemble the front wheels and rear wheels

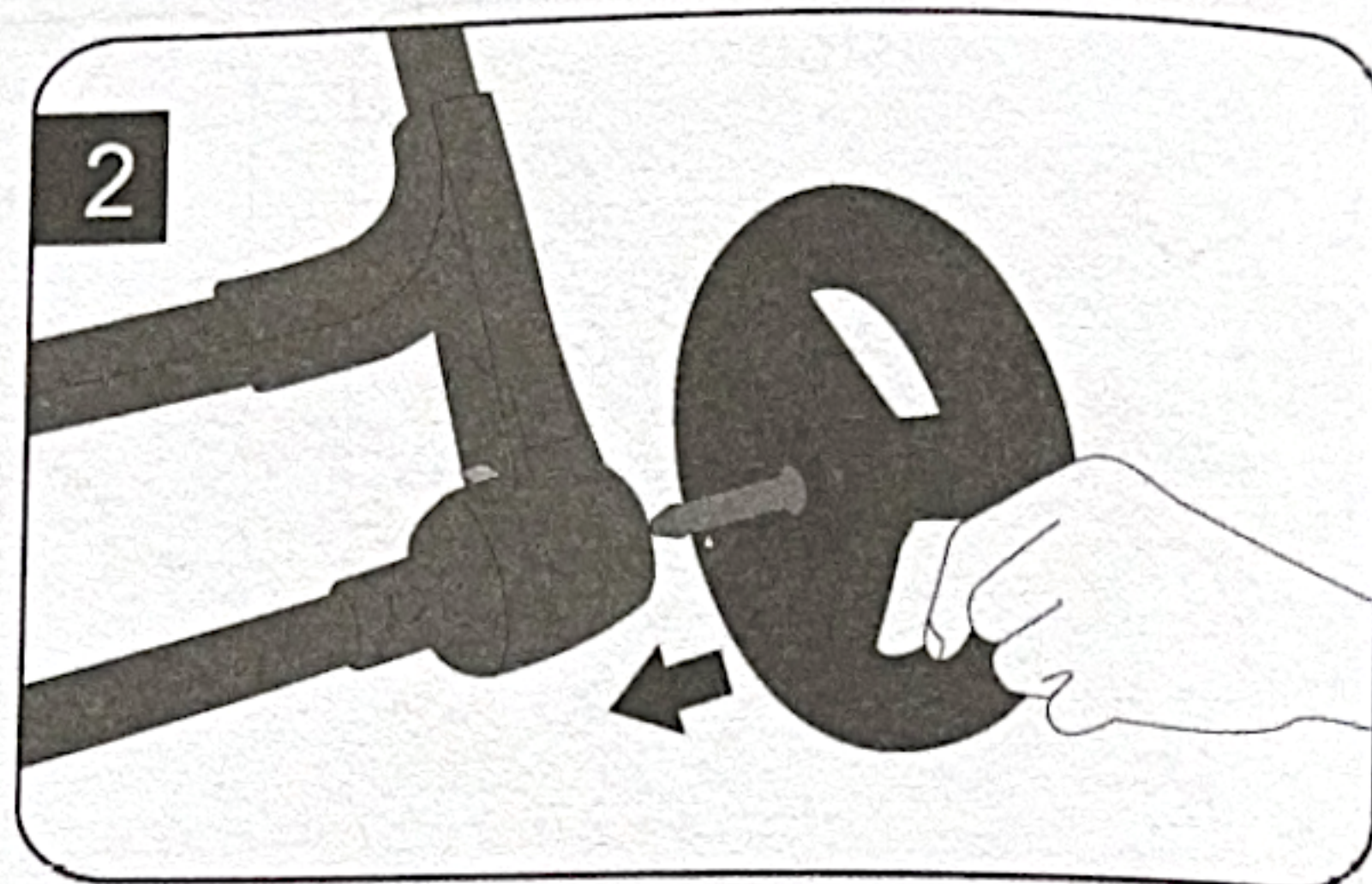
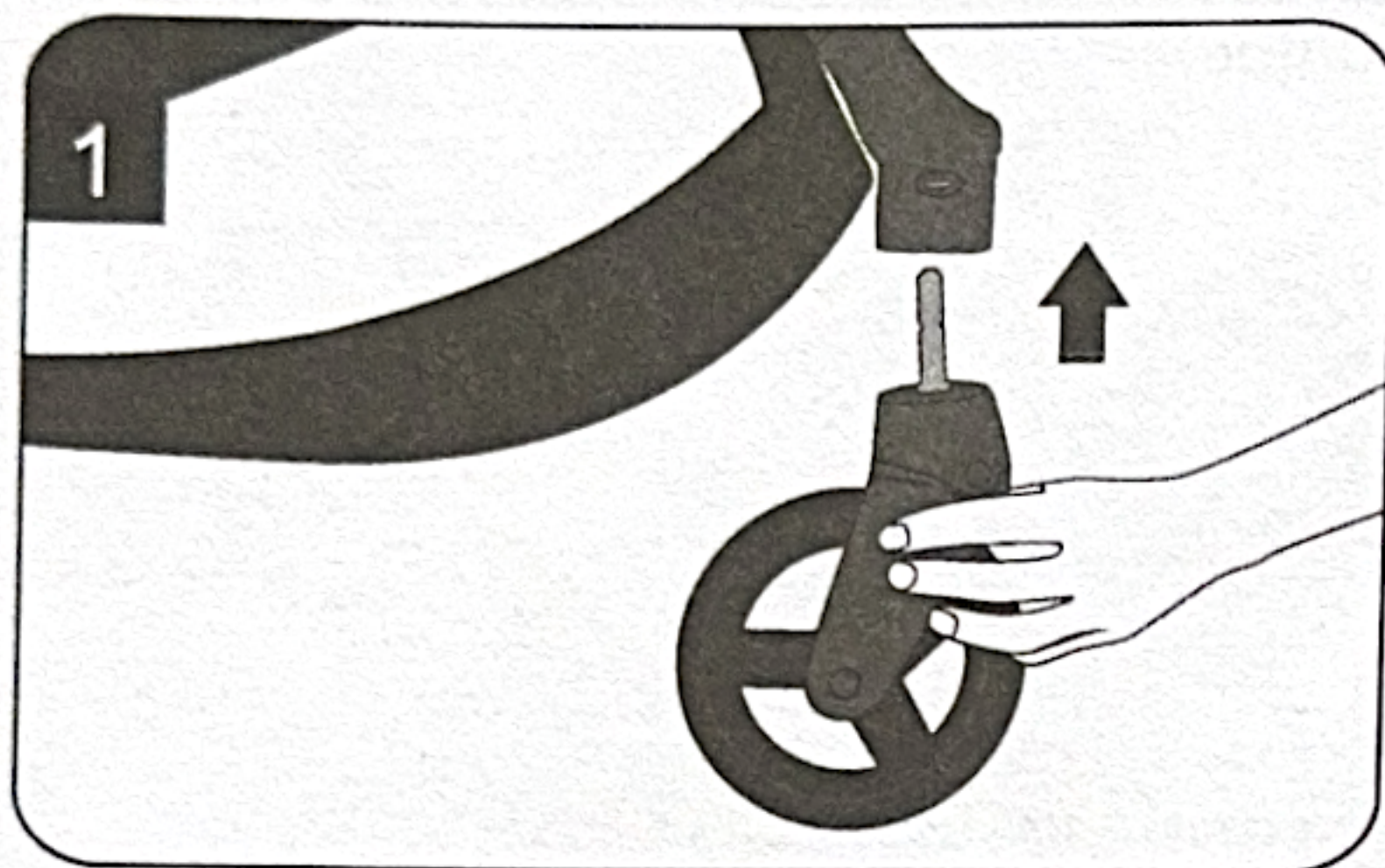

WARNING: Before use, ensure that the wheel units are safely locked into position.

- 1、 Fit the front wheel unit to the stroller and lock it into position until there is a click sound(as pic.1) — Repeat this operation for the other wheel unit.
- 2、 Fit the rear wheel unit to the stroller and lock it into position until there is a click sound(as pic.2) — Repeat this operation for the other wheel unit.

Brake and unbrake

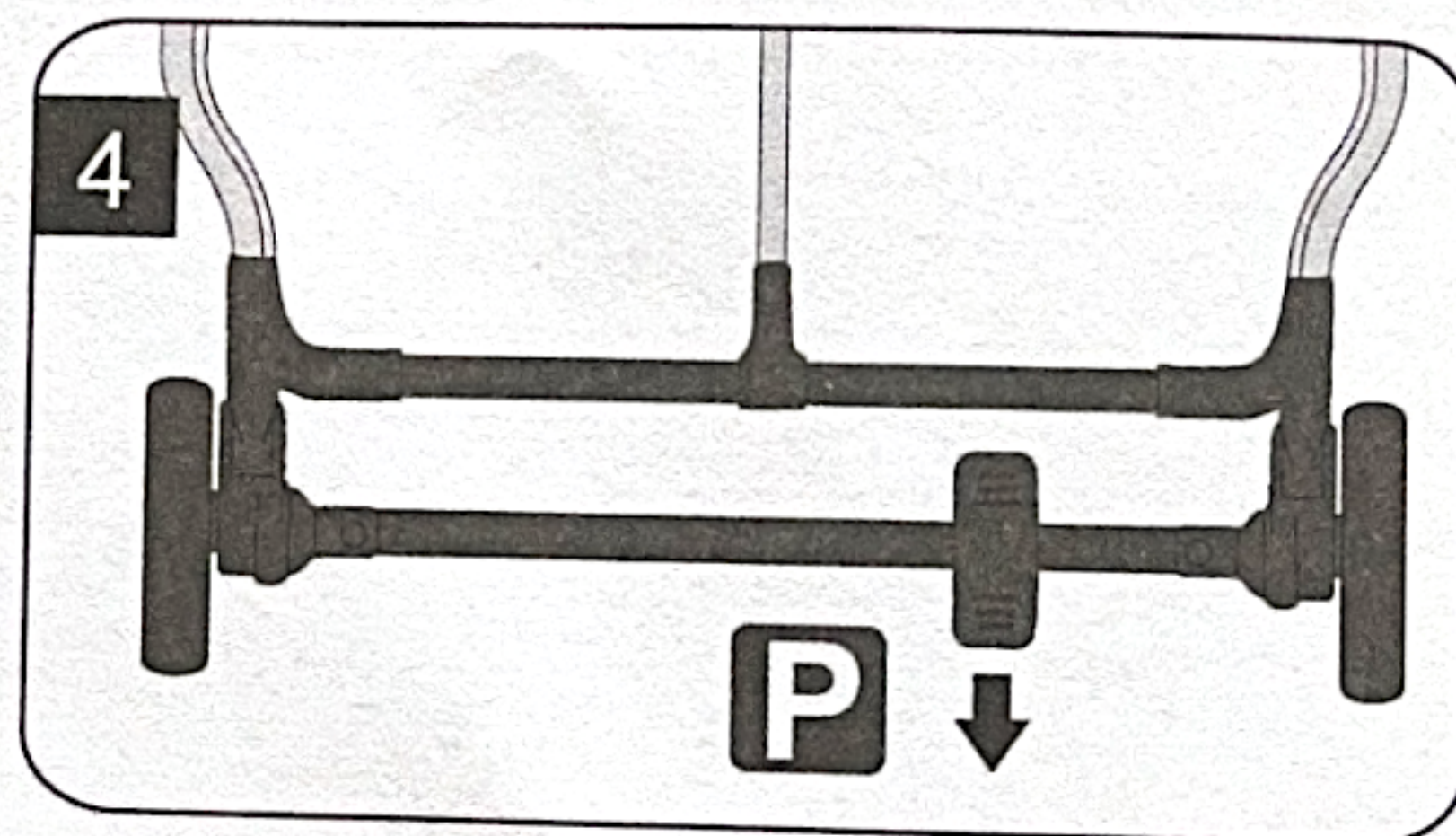
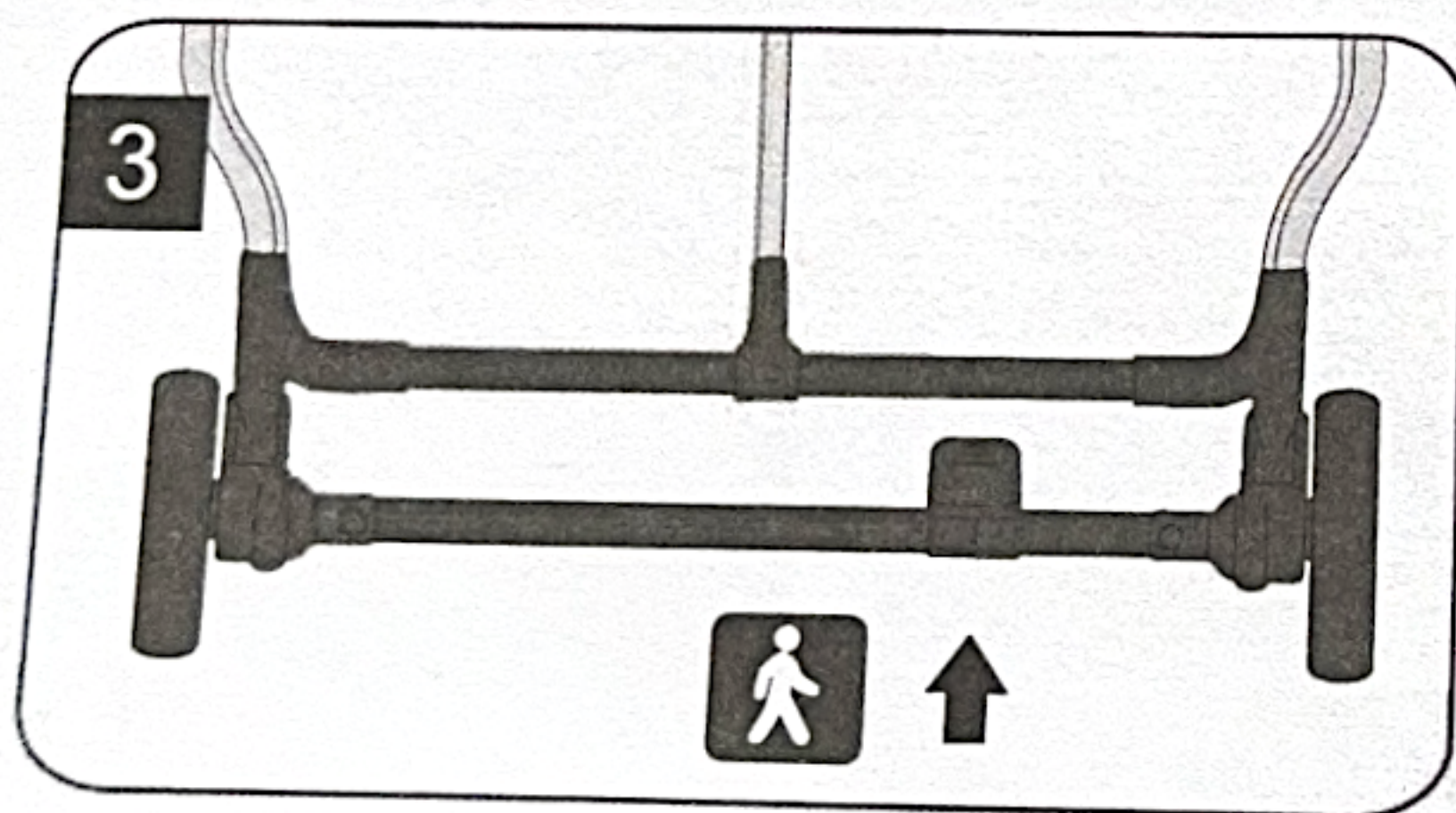

- 3、 As shown in Figure 3, the top pedals can move forward.
- 4、 As shown in Figure 4, step down the middle brake pedal to stop the stroller.